

ZEBCO PSG05

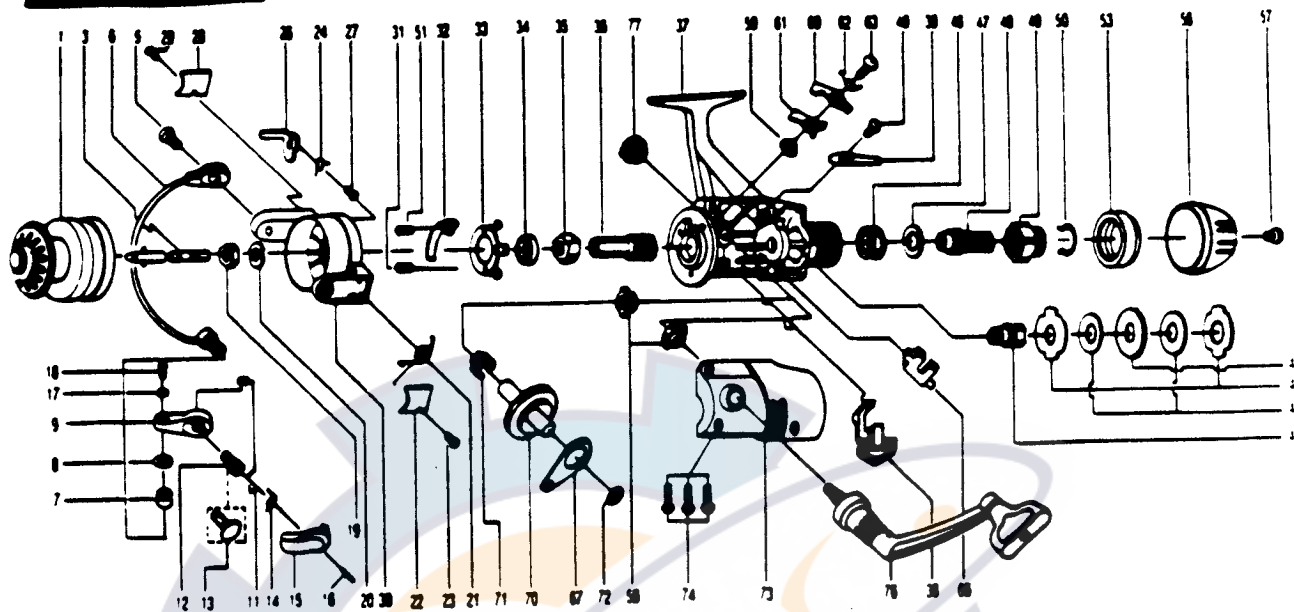

KEY PART NO. NO.	DESCRIPTION	PRICE	KEY PART NO. NO.	DESCRIPTION	PRICE
1 BT321	SPOOL ASSY. - PSG05	5.44	41 BT104	SLIDER HOLDER	.63
2 BT315	MAIN SHAFT ASSY	2.59	42 BT030	REAR DRAG WASHER "A"	1.27
5 BT048	BAIL HOLDER SCREW	.69	43 BT039	REAR DRAG WASHER "B"	1.43
6 BT347	BAIL ARM ASSY.	5.44	44 BT071	REAR DRAG WASHER "D"	.48
7 VB004	LINE ROLLER	1.09	45 BT066	CLICK GEAR	.52
8 VB016	LN ROLLER BUSHING	.63	46 BT031	REAR DRAG COIL SPR.	1.14
9 ST007	ARM LEVER	1.72	47 BT046	REAR DRAG ADJ. WSHR.	1.03
11 BT002	E-CLIP	.85	48 BT112	REAR DRAG NUT	1.09
12 BT113	TRIGGER HOLDER	.58	49 ST017	SLIDING SCREW	1.03
13 BT111	ARM LEVER CAP	1.14	50 BT033	BACK CLICK CLAW	.39
14 BT114	TRIGGER SPRING	.52	51 BT182	KICK LEVER GUIDE SCR	.39
15 BT115	TRIGGER	1.43	53 BT132	REAR DRAG STOPPER	1.43
16 BT116	TRIGGER PIN	.39	56 BT032	REAR DRAG CAP	2.00
17 VB102	BAIL AXLE WASHER	.29	57 VB079	DRAG SCREW	.92
18 VB108	BAIL AXLE SCREW	.58	58 ST013	BODY COVER BUSHING	.69
19 VB006	ROTOR NUT	.58	59 ST014	A/R CLAW BUSHING	.69
20 ST065	ROTOR RETAINER	.58	60 BT063	A/R CLAW (N)	.75
21 ST022	BAIL SPRINGS	.69	61 BT064	A/R CLAW (S)	.75
22 ST087	BAIL SPRING COVER	.69	62 BT061	A/R CLAW SPRING	.39
23 ST085	BAIL SPR.COVER SCREW	.63	63 ST089	A/R CLAW SCREW	.34
24 ST049	KICK LEVER SCREW	.58	66 ST081	PIN SLIDER	.80
26 ST019	KICK LEVER	1.14	67 ST025	OSCILLATING SLIDER	1.27
27 ST037	KICK LEVER SCREW	.34	70 ST012	DRIVE GEAR	3.55
28 ST024	KICK LEVER COVER	.46	71 ST086	SLIDING SPRING	.46
29 ST085	BAIL SPR.COVER SCREW	.63	72 RB026	CRANK GEAR SHIM	.29
30 ST009	ROTOR ASSY	5.85	73 BT323	BODY COVER ASSY.	4.76
31 ST080	BEARING PLATE SCREW	.34	74 ST057	BOLY COVER SCREW	1.14
32 ST082	KICK LEVER GUIDE	1.14	76 VB318	HANDLE ASSY	6.19
33 ST040	BEARING PLATE	.85	77 ST073	HANDLE SCREW CAP	.52
34 RB028	BALL BEARING	5.73	79 BT120	ROTOR RET. SPRG. W/S	.85
35 ST060	RATCHET GEAR	1.83			
36 ST011	PINION GEAR	3.44			
37 BT301	BODY ASSY	10.43			
38 ST059	ANTI-REVERSE LEVER	.58			
39 ST068	CLICK CLAW	.39			
40 ST067	CLICK CLAW SCREW	.29			

* Not shown in diagram
Fits between keys 18 & 20

Prices subject to change without notice. Prices do not include postage and handling.

PLEASE ORDER BY PART NUMBER

Rev. 11/90

Zebco Division Brunswick Corporation, Box 270, Tulsa, OK 74101 USA 918-438-6861

