

ZEBCO PSG40

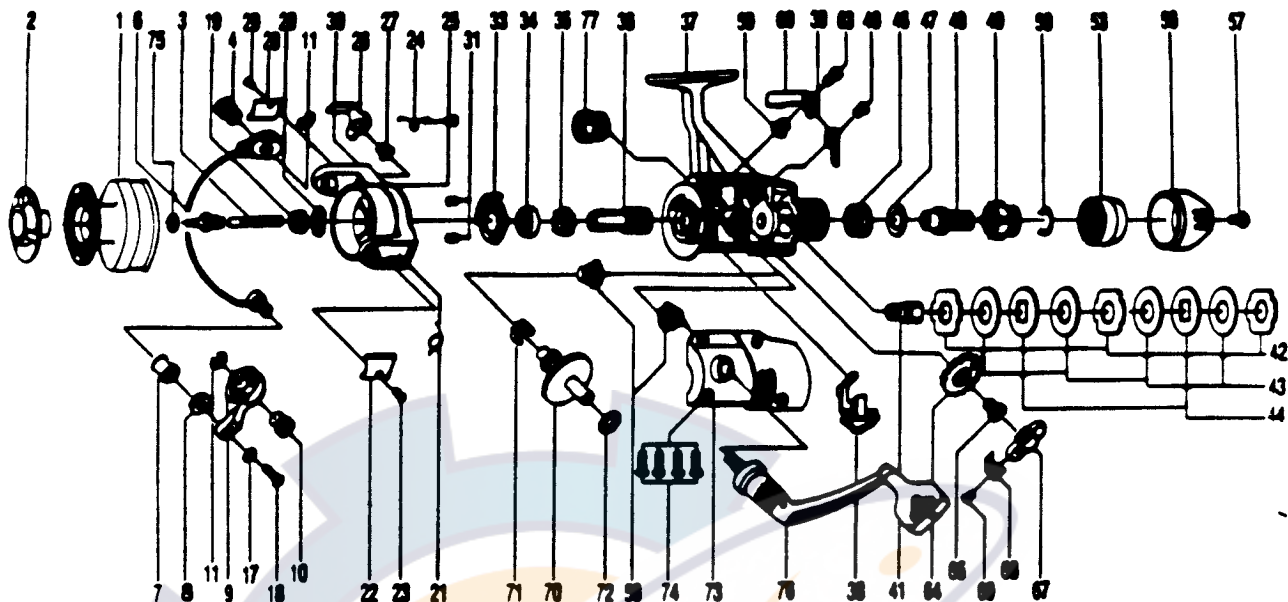

**KEY PART
NO. NO.**

KEY PART NO. NO.	DESCRIPTION	PRICE
1 DT321	SPOOL ASSY.	6.31
3 DT315	MAIN SHAFT ASSY.	2.24
4 DT044	BAIL HOLDER PIN	1.14
6 DT347	BAIL ARM ASSY.	5.16
7 DT004	LINE ROLLER	1.55
8 PB016	LN ROLLER BUSH.	.63
9 PB007	BAIL ARM A	1.72
10 DT043	ARM LEVER PIN	1.37
11 DT002	E-CLIP	.85
17 PB102	BAIL AXLE WASHER	.29
18 PB108	BAIL AXLE SCREW	.39
19 NB006	ROTOR NUT	.85
20 DT065	ROTOR RETAINER	.58
21 DT022	BAIL SPRING	.69
22 PB087	BAIL SPRING COVER	.63
23 BT085	BAIL SPR.COVER SCREW	.63
24 DT049	KICK LEVER SPRING	.58
25 DT058	KICK LEVER SPR. SCR.	.46
26 DT019	KICK LEVER	1.32
27 DT037	KICK LEVER SCREW	.34
28 PB024	TRIP LVR. CVR.	.63
29 BT085	BAIL SPR.COVER SCREW	.63
30 DT009	ROTOR ASSY.	7.46
31 BT080	BEARING PLATE SCREW	.34
33 DT040	BEARING PLATE	1.83
34 NB028	BAIL BEARING	7.97
35 NB060	A/R RATCHET	.98
36 DT011	PINION GEAR	3.61
37 DT301	BODY ASSY	10.37
38 DT059	ANTI-REVERSE LEVER	.58
39 DT068	CLICK CLAM	.39

**KEY PART
NO. NO.**

KEY PART NO. NO.	DESCRIPTION	PRICE
40 BT067	CLICK CLAM SCREW	.29
41 DT104	SLIDER HOLDER	.69
42 DT030	REAR DRAG WSHR. "A"	1.27
43 DT039	REAR DRAG WSHR. "B"	1.43
44 DT071	REAR DRAG WSHR. "D"	1.03
46 DT031	REAR DRAG COIL SPR.	1.27
47 DT046	REAR DRAG ADJ. WSHR.	1.03
48 DT112	REAR DRAG NUT	1.14
49 DT017	SLIDING SCREW	1.14
50 DT033	BACK CLICK CLAM	.46
53 DT132	REAR DRAG STOPPER	1.72
56 DT032	REAR DRAG CAP	2.00
57 DT079	REAR DRAG CAP SCREW	.34
58 BT013	BODY COVER BUSHING	.69
59 DT014	A/R CLAM BUSHING	.69
60 DT063	A/R CLAM (N)	.75
63 DT089	A/R CLAM SCREW	.39
64 NB053	OSCILLATING GEAR	.92
65 NB078	OSC. GEAR SCR.	.39
67 NB025	OSCILLATOR SLIDER	1.95
68 NB083	STOPPER	.39
69 NB084	STOPPER SCREW	.29
70 NB012	CRANK GEAR	3.39
71 NB086	SLIDER SPRING	.39
72 RB026	CRANK GEAR SHIM	.29
73 DT323	BODY COVER ASSY.	5.44
74 DT057	BODY COVER SCREW	1.43
76 NB318	HANDLE ASSY.	6.48
77 CT073	HANDLE SCREW CAP	.52

Prices subject to change without notice. Prices do not include postage and handling.

PLEASE ORDER BY PART NUMBER

Rev. 11/80

Zebco Division Brunswick Corporation, Box 270, Tulsa, OK 74101 USA 918-688-8881

