

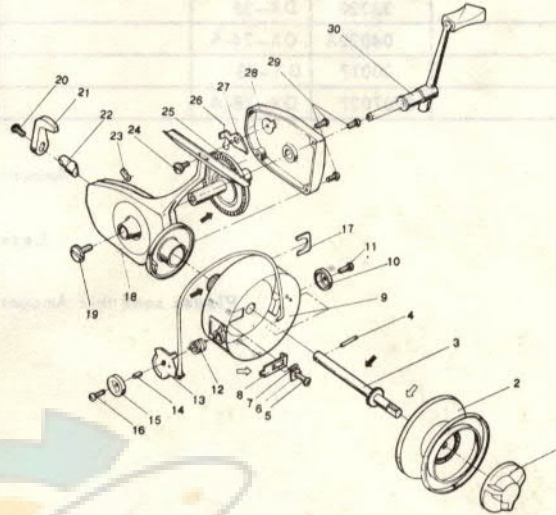

BRUNSWICK CORPORATION
CONSUMER DIVISION
 POST OFFICE BOX 270,
 TULSA, OKLAHOMA 74101

ZEBCO PARTS LIST AND ORDER BLANK MODEL XRL15 SPINNING REEL

PLEASE ORDER BY PART NUMBER, NOT KEY NUMBER



IF REQUIRED REPAIRS CANNOT BE MADE AT YOUR NEAREST FACTORY APPROVED SERVICE STATION, YOU MAY ORDER THE FOLLOWING REPLACEMENT PARTS DIRECT FROM THE FACTORY OR RETURN REEL TO FACTORY.

Your Order No. _____ Date _____
 Charge To _____ Ship To _____
 Address _____ Address _____
 City & State _____ City & State _____

DEFECTIVE PARTS REPLACED AT FACTORY ONLY

KEY NO.	DESCRIPTION	PART NO.		QUANTITY	PRICE	EXTENSION
		OLD	NEW			
1	Drag Knob	32016	OX-32		\$.15	✓
2	Spool Assembly	0206025	OX-21		1.39	
3	Main Shaft	0212061	OX-15-A		.70	✓ ✓
4	Oscillating Pin	23035	OX-66		.10	✓
5	Bail Arm Lever Screw	21001	BX-51		.10	✓
6	Lever Washer	39057	OX-46		.15	
7	Lever Spring	28085	OX-42		.20	
8	Bail Arm Lever	15037	OX-43		.20	✓
9	Rotor	05014	OX-9-A		2.05	
10	Bail Arm Holder	27064	OX-12		.25	
11	Bail Arm Holder Screw	20011	AX-73		.10	
12	Bail Arm Spring	28084	OX-49		.15	
13	Bail Arm Assembly	0229016	OX-10-A		.50	✓
14	Bail Arm Assembly Collar	17010	JX-62		.35	✓
15	Bail Arm Holder	27064	OX-12		.25	
16	Bail Arm Holder Screw	20011	AX-73		.10	✓
17	Rotor Retainer	30007	DX-17		.10	
18	Main Body	03018	OX-1-A		1.80	
19	Handle Retainer Screw	19050	FX-3		.15	
20	Anti-Reverse Lever Screw	21001	BX-51		.10	✓

(Continued on Reverse Side)

KEY NO.	DESCRIPTION	PART NO.		QUANTITY	PRICE	EXTENSION
		OLD	NEW			
21	Anti-Reverse Lever	05014	DX-52		\$.15	
22	Anti-Reverse Lever Cam	14017	DX-36		.15	
23	Anti-Reverse Lever Spring	28042	DX-37		.10	
24	Anti-Reverse Claw Screw	19003	DX-38		.20	
25	Main Gear	08021	OX-8-A		.50	
26	Anti-Reverse Claw Spring	28057	DX-39		.15	
27	Anti-Reverse Claw	33020	DX-35		.10	
28	Side Plate	04022A	OX-24-A		.60	
29	Side Plate Screw	20017	DX-73		.10	✓
30	Handle Assembly	0207027	OX-18-A		1.30	✓