

# ZEBCO ZX60

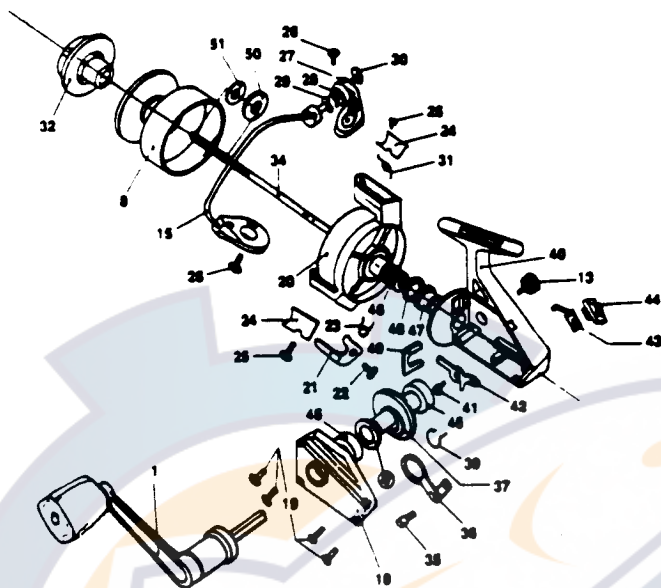

**KEY PART  
NO. NO.**

NO.	DESCRIPTION	PRICE
1	KK318 HANDLE ASSY.	6.38
8	KK321 SPOOL	9.89
13	JK073 HANDLE SCREW CAP	.91
15	KK347 BAIL ASSY.	4.18
18	KK323 SIDE PLATE	3.16
19	JK057 SIDE PLATE SCREW	.37
20	KK009 ROTOR	4.23
21	KK019 STOP LEVER	1.71
22	KK037 STOP LEVER SCREW	.54
23	KK047 STOP LEVER SPRING	.85
24	KK087 ROTOR COVER	1.87
25	KK085 ROTOR COVER SCREW	.37
26	KK051 ANGLE LEVER SCREW	.59
27	KK007 ANGLE LEVER	1.66
28	KK016 LINE ROLLER WASHER	.54
29	JK004 LINE ROLLER	.97
30	JK108 LINE ROLLER SCREW	.37
31	KK049 TURNING SPRING	.91
32	KK050 DRAG KNOB ASSY.	1.87
34	KK315 MAIN SHAFT ASSY.	1.87
35	KK084 OSCILLATOR SLIDER PIN	.70
36	KK025 OSCILLATOR SLIDER ARM	1.56
37	KK012 DRIVE GEAR	3.48
38	JK026 DRIVE GEAR WASHER	.54
39	KK213 DRIVE GEAR SPRING	.80
40	KK301 BODY ASSY.	6.43
41	KK089 ANTI-REVERSE PAWL SCREW	.54
42	KK063 ANTI-REVERSE PAWL	1.29
43	JK090 ANTI-REVERSE SPRING	1.44
44	JK059 ANTI-REVERSE LEVER	.70
45	JK013 SIDE PLATE BUSHING	.70
46	KK011 PINION GEAR	1.87
47	KK126 PINION GEAR BUSHING	.85
48	KK010 PINION GEAR WASHER	.54
49	KK125 ROTOR HOLDING PLATE	.54
50	KK161 CLICK	.85
51	KK162 CLICK WASHER	.59

Prices subject to change without notice. Prices do not include postage and handling.

**PLEASE ORDER BY PART NUMBER**

Rev. 11/90

Zebco Division Brunswick Corporation, Box 270, Tulsa, OK 74101 USA 918-638-6681

