

**ZEBCO PARTS LIST AND ORDER BLANK
MODEL 822 SPIN FLO SPINNING REEL**

Canadian Prices 25% Higher

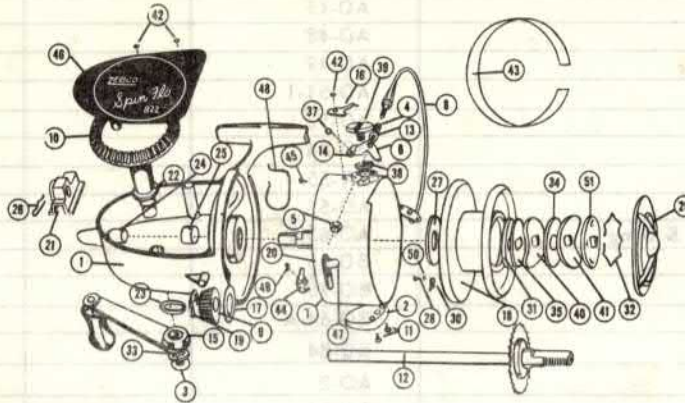

IF REQUIRED REPAIRS CANNOT BE MADE AT YOUR NEAREST FACTORY APPROVED SERVICE STATION, YOU MAY ORDER THE FOLLOWING REPLACEMENT PARTS DIRECT FROM THE FACTORY OR RETURN REEL TO FACTORY.

Your Order No. _____ Date _____

Charge To _____ Ship To _____

Address _____ Address _____

City & State _____ City & State _____

DEFECTIVE PARTS REPLACED AT FACTORY ONLY

REF. NO.	DESCRIPTION	PART NO.	QUANTITY	PRICE	EXTENSION
1	Body Assembly	BO-1-2-SA		\$ 3.50	
2	Counter Weight	BO-2-1		.25	
3	Handle Screw	AO-3		.25	
4	Line Roller	AO-4		.35	
5	Bail Nut	AO-6		.25	
6	Bail Bracket Assembly	AO-7-SA		.40	
7	Cowl	BO-9-1-SA		2.00	
8	Bail Axle Assembly	AO-10-1-SA		2.00	
9	Pinion Gear	AO-11		.50	
10	Crank Gear	AO-12-1-SA		1.50	
11	Bail Retainer Screw	AO-14-F		.05	
12	Center Shaft Assembly	BO-15-SA		1.40	
13	Bail Roller Retainer	AO-16		.20	
14	Bail Bracket Adjustment Screw	AO-17		.10	
15	Crank Handle Assembly	AO-18-1-SA		.90	
16	Bail Detent Spring	AO-19		.15	
17	Pinion Washer	BO-19		.10	
18	Spool (Inc. Brake)	BO-21		3.15	
19	Pinion Retainer Clip	AO-22		.10	
20	Pawl Stud	BO-25		.10	
21	Level Wind Slide	AO-25		.35	
22	Bearing	AO-26-1		.30	
23	Bearing	BO-26-1		.40	
24	Bearing	BO-27		.40	
25	Bearing	BO-28		.40	
26	Slide Retainer Clip	AO-29		.10	
27	Washer - Fiber	AO-30		.10	
28	Screw	AO-31-2		.10	
29	Brake Adjustment Nut	BO-32		.50	
30	Clicker	AO-33-2		.10	
31	Washer - Fiber	BO-35		.10	
32	Snap Ring	AO-36		.10	
33	Lock Washer	AO-38		.05	

(Continued on reverse side)

REF. NO.	DESCRIPTION	PART NO.	QUANTITY	PRICE	EXTENSION
34	Washer	AO-39		.10	
35	Washer	AO-45		.10	
37	Lock Nut	AO-48		.05	
38	Bail Return Spring	AO-49		.25	
39	Bail Screw	AO-51-1		.35	
40	Spring Washer-Blue	AO-53		.10	
41	Spring Washer-Red	BO-54		.10	
42	Screw	AR-55		.10	
43	Line Clip	AO-55		.50	
44	Anti Reverse Pawl & Drag	AO-63-2		.25	
45	Bumper	BO-65		.10	
46	Name Plate	BO-75		.30	
47	Anti-R-Actuator	BO-64-A		.35	
48	Pawl Spring	BO-84		.15	
49	Anti-R-Screw	AO-2		.10	
50	Click Washer	BZ-25		6/ .10	
	Bail Washer (Not Shown)	AO-82		.05	
51	Nylon Washer	FO-83		.25	

EXTRA SPOOLS OF LINE FOR MODEL 822

	Spool with 4-lb. test line	BO-21-4		5.25	
	Spool with 6-lb. test line	BO-21-6		5.25	
	Spool with 8-lb. test line	BO-21-8		5.25	
	Spool with 10-lb. test line	BO-21-10		5.25	