

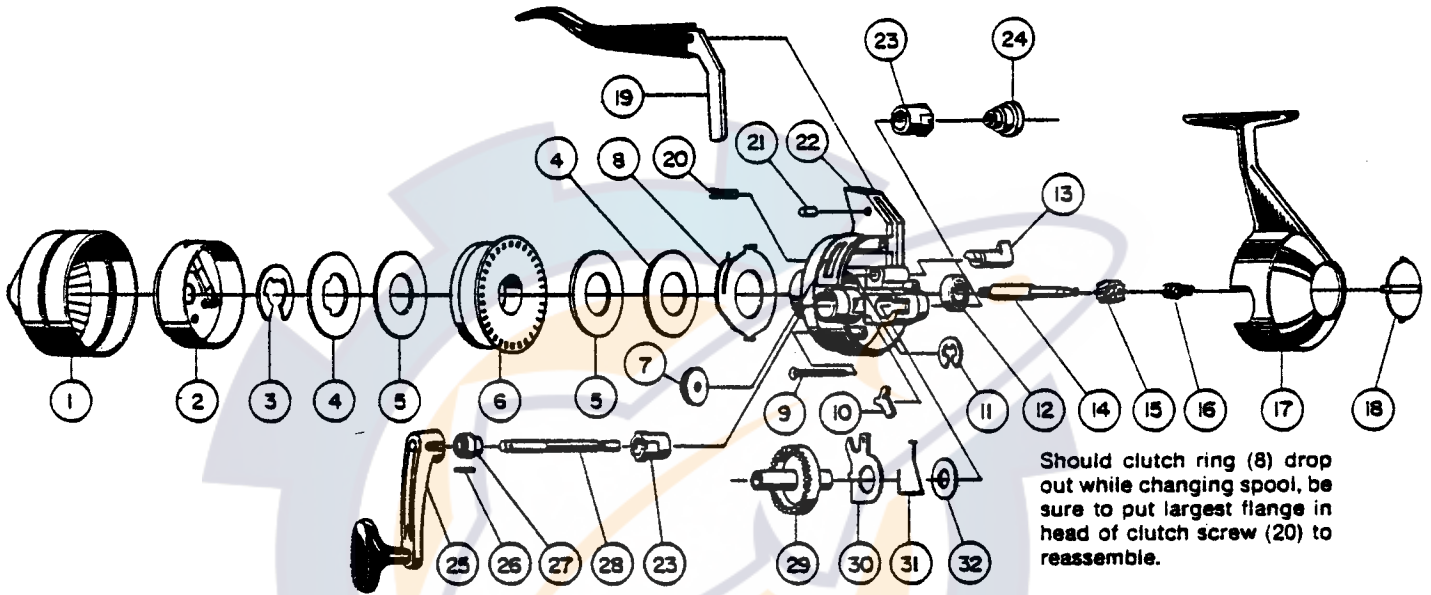

# STERLING™ 50SR™

## CLOSED-FACE SPINNING REEL

weight	10.5 oz./298 g		
pound test	8	10	12
yards	120	110	90
meters	110	101	82
gear ratio	3.5:1		



Should clutch ring (8) drop out while changing spool, be sure to put largest flange in head of clutch screw (20) to reassemble.

### MODEL 50SR

Key No.	Part No.	Description	Key No.	Part No.	Description
1	CJ324-4	Front Cover (Sterling)	17	CJ023	Back Cover
2	CJ310	Spinner Head	18	DJ075	Back Cap
3	GZ034	Retainer Clip	19	CJ350	Finger Brake
4	CJ040	Spool Washer	20	BJ054	Clutch Screw
5	CJ108	Flat Washer	21	CJ172	Finger Brake Pin
6	CJ021	Spool (Empty)	22	CJ301-3	Body Assy.(G) w/Bearing
	CJ321-10T	Spool w/10# Trilene	23	CJ026	Crank Bearing
7	CJ032	Clutch Wheel	24	DJ769-2	Crank Rod Nut (SR)
8	CJ027	Clutch Ring	25	CJ318-3	(SR) Crnk. Hdl. (25-28)
9	CJ126	Machine Screw	26	CJ171	Crank Handle Pin
10	CJ060	Anti-Reverse Pawl	27	DJ068	Crank Rod Spacer
11	BJ121	Retaining Clip	28	CJ067	Crank Rod
12	AZ028	Ball Bearing	29	CJ012	Crank Gear
13	CJ002	Anti-Reverse Actuator	30	CJ014	Anti-Reverse Drag
14	CJ015	*Center Shaft	31	CJ061	Anti-Reverse Pawl Sprg.
15	CJ011	*Pinion Gear	32	CJ106	Washer
16	DJ020	*Center Shaft Spring			

\*Available as One Unit,  
CJ315 Center Shaft Assy.

PLEASE ORDER BY PART NUMBER

Zebco Division Brunswick Corporation, Box 270, Tulsa, OK 74101 USA 918-836-5581

