

STERLING™ 60SR™

CLOSED-FACE SPINNING REEL

weight	18.5 oz./440 g		
pound test	12	14	17
yards	180	165	125
meters	165	151	114
gear ratio	3.8:1		

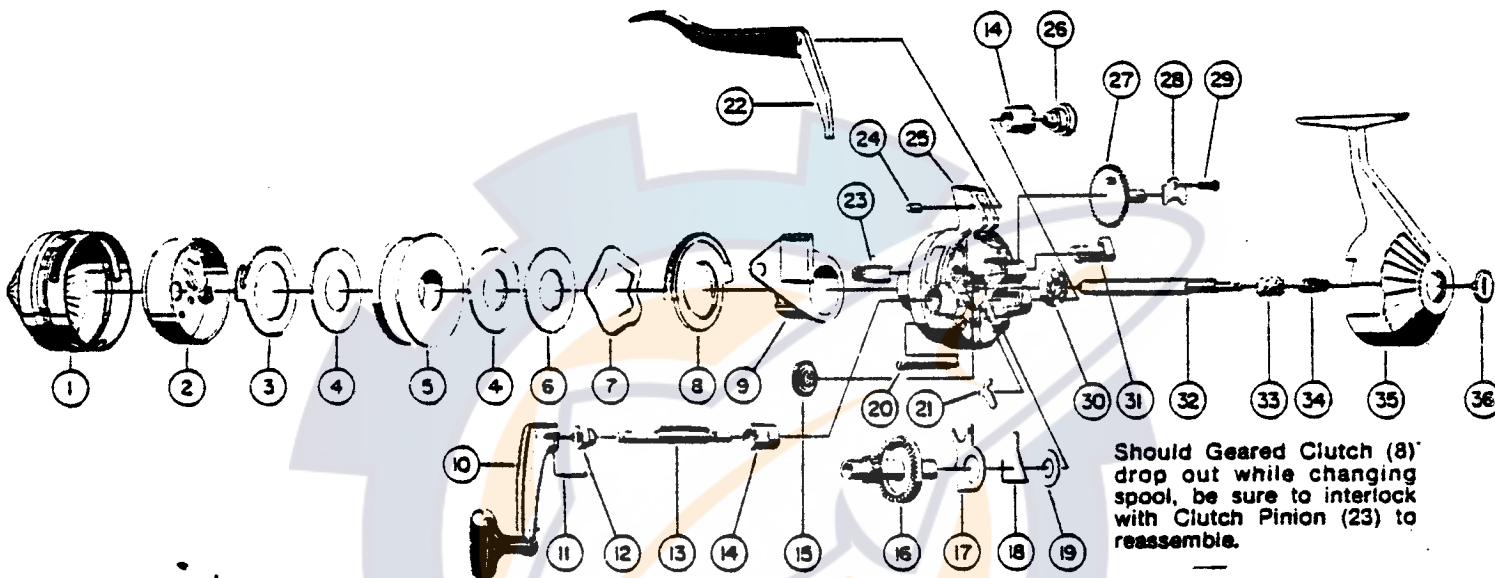

Should Geared Clutch (8) drop out while changing spool, be sure to interlock with Clutch Pinion (23) to reassemble.

DEL 60SR

Key No.	Part No.	Description	Key No.	Part No.	Description
1	DJ324-1	Front Cover Assy. (SR)	19	CJ106	Pawl Spring Washer
2	DJ310	Spinner Head Assy.	20	CJ126	Machine Screw
3	DJ034	Spool Clip	21	CJ060	Anti-Reverse Pawl
4	DJ108	Flat Washer	22	DJ350	Finger Brake Assy.
5	DJ021	Spool (Empty)	23	DJ054	Clutch Pinion
	DJ321-17T	Spool w/17# Trilene	24	CJ172	Finger Brake Pin
6	DJ040	Spool Washer	25	DJ301-3	Body Assy. (SR)w/Bearing
7	DJ027	Clutch Ring	26	DJ769-2	Crank Rod Nut (SR)
8	DJ197	Geared Clutch	27	DJ190	Oscillator Gear
9	DJ189	Spool Carrier	28	DJ199	Oscillator Gear Ret.
10	DJ318-2	Crank Handle (SR/11-13)	29	AJ057	Retainer Screw
11	CJ171	Crank Handle Pin	30	AZ028	Ball Bearing
12	DJ068	Crank Handle Spacer	31	DJ002	Anti-Rev. Actuator
13	DJ067	Crank Rod	32	DJ015	*Center Shaft
14	CJ026	Crank Bearing	33	CJ011	*Pinion Gear
15	DJ032	Clutch Wheel	34	DJ020	*Center Shaft Spring
16	DJ012	Crank Gear	35	DJ023	Back Cover Assy.
17	CJ014	Anti-Reverse Drag	36	DJ075	Back Cap
18	CJ061	Anti-Rev. Pawl Spring			

*Available As One Unit,
DJ315 Center Shaft Assy.

PLEASE ORDER BY PART NUMBER