

BROWNING® MZ78, MZ910 and MZ1011

SPECIFICATIONS:

Single-action, Disc Drag

MZ78

7.6 oz. Weight
WF8F plus 200 yds. 20#
backing capacity

MZ910

8.5 oz. Weight
WF9F plus 200 yds. 30#
backing capacity

MZ1011

9.6 oz. Weight
WF10F plus 300 yds. 30#
backing capacity

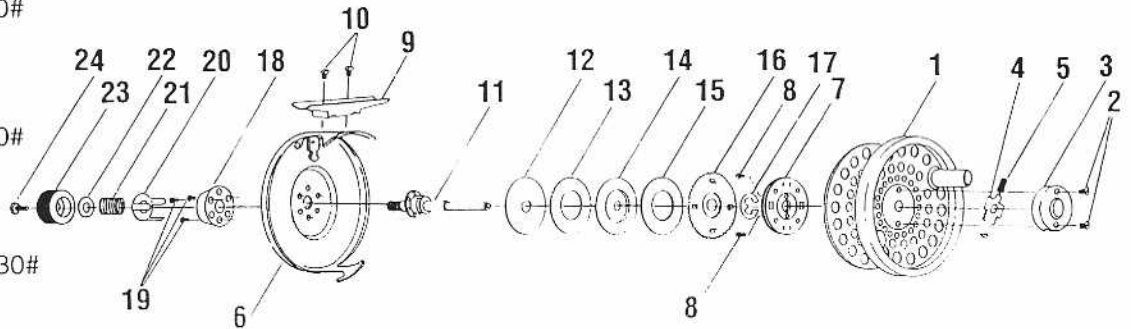

FEATURES:

- Machined from 6061-T6 aluminum bar stock
- Floating Teflon/Rulon and stainless steel disc drag
- Independent on/off click
- Counterbalanced rim control spool
- Replaceable reel feet and easy-grip crank knobs
- Made in USA

ReelSchematic

Key No.	MZ78 Part No.	MZ910 Part No.	MZ1011 Part No.	Description	Price
1	BMZ78S	N/A	N/A	Spool Assembly	.48
1	N/A	BMZ910S	N/A	Spool Assembly	.57
1	N/A	N/A	BMZ1011A	Spool Assembly	.58
2	RR130-10A	RR130-10A	RR130-10A	Spool Lock Cap Screw	.20
3	239-01APD	239-02APD	239-03APD	Spool Lock Cap	4.55
4	XM050-01A	XM050-01A	XM050-01A	Spool Lock	.80
5	253S	253S	253S	Spool Lock Spring	.32
6	S-1-MZ78-01CMP	S-1-MZ910-01CMP	S-1-MZ1011-01CMP	Body Assembly	35.00
7	1209PP	1209PP	1209PP	Clutch Assembly	5.30
8	RR130-09A	RR130-09A	RR130-09A	Clutch Screw	.75
9	898B-01A	898B-01A	898B-01A	Reel Foot	9.35
10	LC196-01A	LC196-01A	LC196-01A	Reel Foot Screw	1.75
11	DM015-01A	DM015-02A	DM015-03A	Spindle	9.40
12	829S-01A	829S-01A	829S-01A	Pressure Plate	.85
13	RR111-12A	RR111-12A	RR111-12A	Rulon Washer	.90
14	DM040-01A	DM040-01A	DM040-01A	Pressure Plate	1.85
15	RR111-10A	RR111-10A	RR111-10A	Teflon Brake Liner	.90
16	QC027-01A	QC027-01A	QC027-01A	Ratchet Friction Plate	3.50
17	RR190-04A	RR190-04A	RR190-04A	Retaining Ring	.60
18	360-02A	360-02A	360-02A	End Cap	6.25
19	RR130-04A	RR130-04A	RR130-04A	End Cap Screw	1.60
20	QC169-01A	QC169-01A	QC169-01A	Plunger Spring	5.00
21	QC108-02A	QC108-02A	QC108-02A	Drag Disc Spring	.80
22	532	532	532	Washer	.10
23	368-02A	368-02A	368-02A	Drag Nut	6.90
24	RR130-08A	RR130-08A	RR130-08A	Drag Knob (Spindle) Screw	2.10

MODEL INTRODUCED	EFFECTIVE DATE OF PARTS LIST/DIAGRAM	Oct. 1996	DISCONTINUED	N/A
------------------	--------------------------------------	-----------	--------------	-----

Prices subject to change without notice. Prices do not include postage and handling.

PLEASE ORDER BY PART NUMBER Zebco Division Brunswick Corporation, Box 270, Tulsa, OK 74101 USA 918-831-6965

